

I

# SWEP B120T

The B120T has been specially developed to operate in demanding heating and industrial applications, typically water-water applications and oil coolers. The product has contributed to the rapid switch to BPHEs from traditional gasket plate heat exchangers and shell-and-tube solutions. It is widely used as a condenser in air conditioning and refrigeration.



Maximum number of plates (NoP)	250
Max flow	27.4 m³/h (120.64 gpm)
Channel volume	0.241/0.241 dm³ (0.0085/0.0085 ft³)
Material	316/316L stainless steel plates, copper brazing
Weight excl. connections	8.33+(0.404*NoP) kg 18.36+(0.891*NoP) lb
Max Particle Size (mm)	1

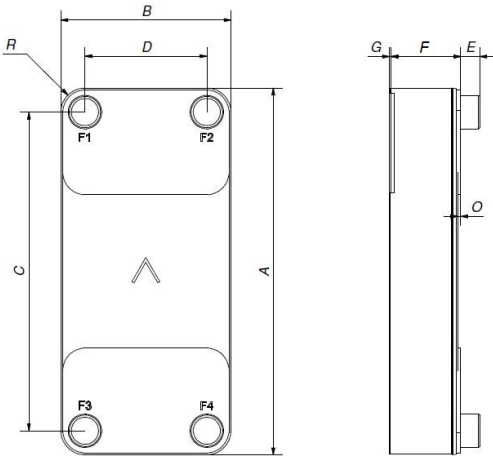

#	MM	IN
A	525	20.67
B	243	9.57
C	456	17.95
D	174	6.85
F	10,00+2,29*(NoP)	0.39+0.09 *(NoP)
G	4	0.16
R	35	1.38
E_1	27	1.06
E_2	54	2.13



Threaded Connection    Victaulic Connection    Solder Connection    Combo Connection    Flange Connection    O-Ring Connection    Weld Connection

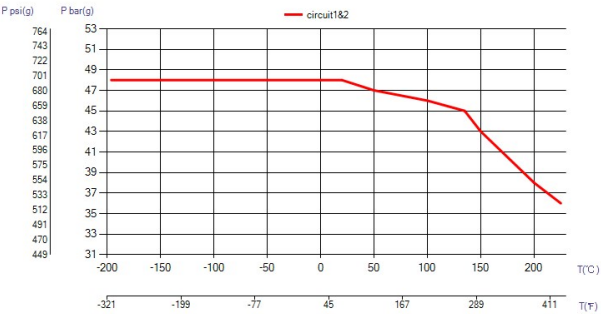

### UL Tryck/Temperatur

