

SWEP V400

Not Available Yet! Translation Ongoing!

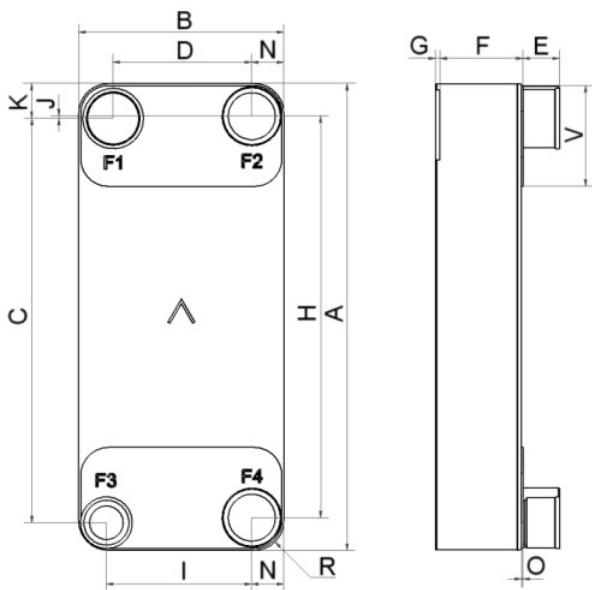

m³/h



#	MM	IN
694		27.32
304		11.97
601		23.66
207.50		8.17
18,00+2,34*(NoP)		0.71+0.09 *(NoP)
0.50		0.02
597		23.5
215.50		8.48
3.50		0.14
52		2.05
47.50		1.87
2		0.08
44		1.73
150		5.91
54		2.13

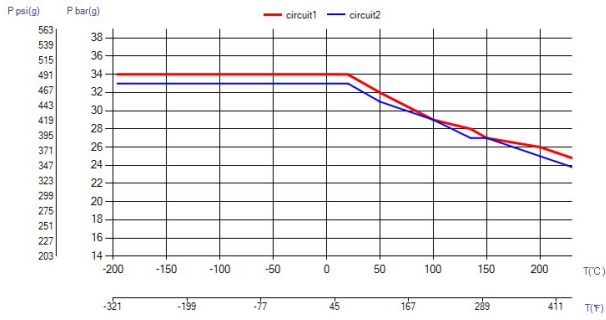

UL Tryck/Temperatur

