

# SWEP B65

The B65 is the perfect choice for high-capacity applications where the most robust plate heat exchanger is sought. With different plate combinations, it offers a solution for the most demanding industrial and heating applications, and is also a very effective condenser.

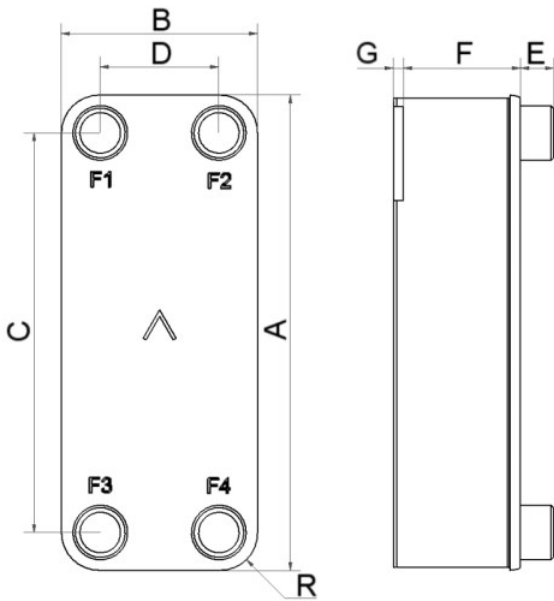

<b>Maximum number of plates (NoP)</b>	360
<b>Max flow</b>	155.5 m <sup>3</sup> /h (684.65 gpm)
<b>Channel volume</b>	0.599/0.599 dm <sup>3</sup> (0.0212/0.0212 ft <sup>3</sup> )
<b>Material</b>	316/316L stainless steel plates, copper brazing
<b>Weight excl. connections</b>	27.44+(1.03*NoP) kg 60.50+(2.271*NoP) lb
<b>Max Particle Size (mm)</b>	1



#	MM	IN
A	864	34.02
B	363	14.29
C	731	28.78
D	231	9.09
E_1	54	2.13
E_2	112	4.41
F	17+2.32*(NoP)	0.67+0.09 *(NoP)
G	0.5	0.02
R	67	2.64

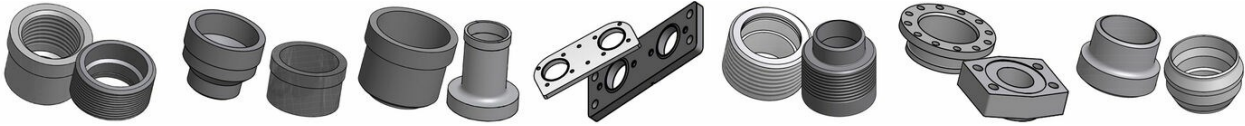

Threaded Connection    Victaulic Connection    Solder Connection    Connection Plate    Combo Connection    Flange Connection    Weld Connection

